

Ladfordfields R.I.E. 3

Number	Location	Application Number	Decision	Decision Notice	Location Plan
1	Ladford Pool Farm, Woodseaves Road, Great Bridgeford	12/16590/COU	Approved	Yes	PSA/SRG/01



C/O Paul Sharpe Associates LLP FAO Paul Sharpe The Old Rectory Burytown Lane Broad Blunsdon Swindon Wilts SN26 7DQ United Kingdom	Date Registered	13 January 2012
	Decision Date	31 July 2012
	Issued Date	31 July 2012

PeFuZ

TOWN AND COUNTRY PLANNING ACT 1990

PERMISSION FOR DEVELOPMENT

Application No:	12/16590/COU
Proposed Development	Continued use for parking/storage of tractor and trailer units, plant and equipment and pipe laying vehicles.
Location	Ladford Pool Farm Woodseaves Road Great Bridgeford
O. S. Reference:	386083 326474

Stafford Borough Council, in pursuance of powers under the Town and Country Planning Act, hereby permits the above development in accordance with the accompanying plans and subject to the following condition :-

1. Only vehicles and machinery owned by the applicants (Stan Robinson Group Ltd) shall be stored on the site.

The reasons for the Council's decision to grant permission for the development subject to the above conditions are:

1. To safeguard the amenities of the area. (Saved Policy E&D16 of the Stafford Borough Local Plan 2001).

Stafford Borough Council

Civic Centre, Riverside, Stafford, ST16 3AQ, DX 723320, Stafford 7

TEL 01785 619 000 EMAIL info@staffordbc.gov.uk

WEB www.staffordbc.gov.uk



2006-2007
*Transforming the Delivery of
Services Through Partnerships*
2009-2010
*Raising economic prosperity
through partnership*





C/O Paul Sharpe Associates LLP FAO Paul Sharpe The Old Rectory Burytown Lane Broad Blunsdon Swindon Wilts SN26 7DQ United Kingdom	Date Registered	13 January 2012
	Decision Date	31 July 2012
	Issued Date	31 July 2012

PeFuZ

TOWN AND COUNTRY PLANNING ACT 1990

PERMISSION FOR DEVELOPMENT

INFORMATIVE(S)

- 1 The reasons for the grant of Planning Permission are set out in the 'Issues' section of the attached officer report. Longer reports include a separate 'Summary' section. The report also includes a separate 'Policies' section, which lists the relevant policies taken into account in the determination of the application. This is to comply with The Town and Country Planning (Development Management Procedure) (England) Order 2010.

Head of Planning and Regeneration
On behalf of the Council

Stafford Borough Council

Civic Centre, Riverside, Stafford, ST16 3AQ, DX 723320, Stafford 7
TEL 01785 619 000 EMAIL info@staffordbc.gov.uk
WEB www.staffordbc.gov.uk



2006-2007
*Transforming the Delivery of
Services Through Partnerships*
2009-2010
*Raising economic prosperity
through partnership*



**INVESTORS
IN PEOPLE**

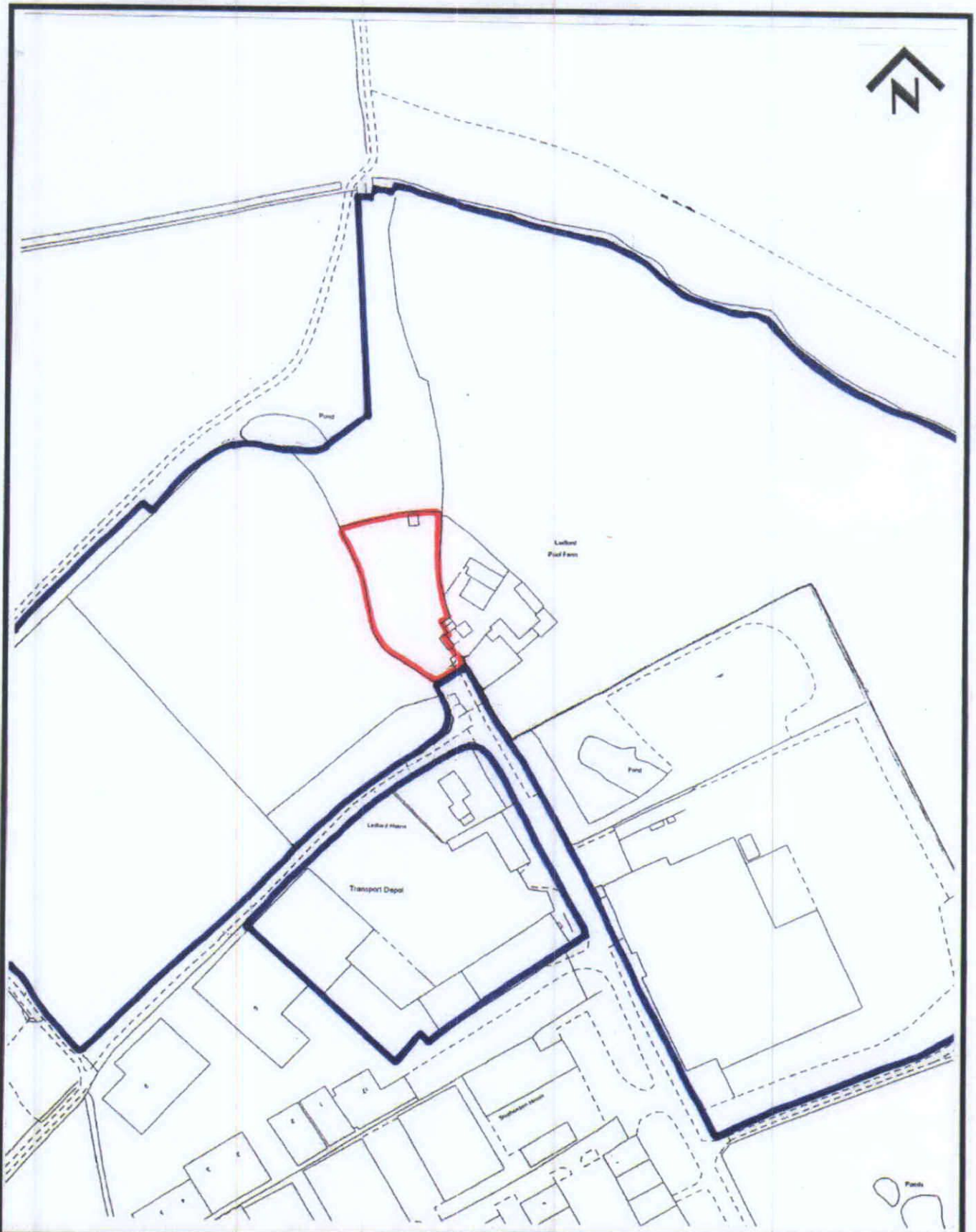

PAUL SHARPE ASSOCIATES LLP
TOWN PLANNING · MANAGEMENT · MARKETING

The Old Rectory, Broad Blunsdon
SWINDON SN26 7DQ
Tel 01793 700420
Fax 01793 700419
e-mail - paul@paulsharpeassoc.co.uk

Client
STAN ROBINSON GROUP LIMITED

Drawing Title
LOCATION PLAN

Project
LAND AT LADFORDPOOL FARM, SEIGHFORD

Date
JAN 2012

Scale
1:2500 *0A4*

Drawing No
PSA/SRG/01